

size::280x210mm

## ASSEMBLY INSTRUCTION



Extend the leg poles.



Connect the upper and lower half of the body.



Insert the batteries and turn on the switch to activate the sound sensor.



Finish!

## HALLOWEEN HANGING FIGURINE ASSEMBLY INSTRUCTIONS

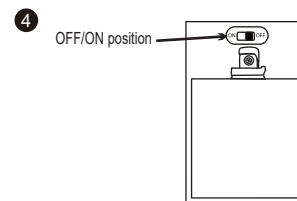
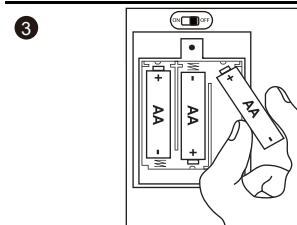
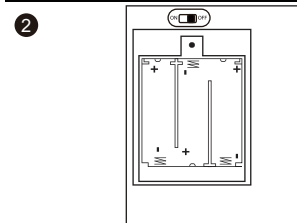
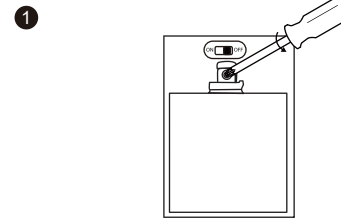

1. Your animatronic may require some fluffing and posing due to resting in its box during shipping. Simply fluff up the fabric by hand to make sure it lays/hangs in the correct position. Pose the arms or body by gently to shape your figurine to your liking. Then find a loop on your figure to hang them up!

2. Use a screwdriver to open the battery pack and insert AA OR AAA batteries according to your purchased Halloween decor. Close the battery pack and move the switch to "ON". (Above is shown how to use, not the exact battery type)

3. Sound-Activated. Please note your figure is built-in Sound-Activated. When you make a sound, the figure will start lighting and make sound. Please always make sure the switch is "on" when you try to Sound-Activated

### WARNING:

1. This product is for indoor or covered outdoor use only. Do not place in direct sunlight.
2. This product is for decoration only and is not a toy. Please use caution with children under the age 8.
3. Do not position the decoration near candles, sources of heat, or in direct sunlight.
4. The decoration cannot be connected to the power supply directly.
5. Decoration should be on a level, stable surface to prevent it from falling over
6. This product is fragile and should be assembled with care.



WARNING:  
CHOKING HAZARD - SMALL PARTS.  
KEEP AWAY FROM CHILDREN